

# Mio 3PH-D

SPOT



## DESCRIPTION

Mio 3PH-D — a technically well-engineered luminaire designed for a three-phase track system. In this model, the driver is positioned outside the housing, ensuring more efficient cooling and simplifying installation. It is suitable for large spaces with high requirements for both aesthetics and functionality.

An optional version with a segmented reflector made of MIRO-Silver® material (designation S) is available, increasing luminous efficiency up to 97%.



**Anti-glare ring:** for increased visual comfort provided by the honeycomb filter. Small body size.



**Small body size.**  
The lamp is ideal for any interior and will not distract unnecessary attention.



**Large selection of opening angles.**  
With the help of various reflectors, the luminaire can create a narrow or wide beam of accent light.



## General specifications

Type of luminaire	Spot (spot light module)
Application areas	Accent lighting
Supply unit	LED Driver integrated
Nominal voltage	230V, 50Hz
Lighting technology	LED COB
Optic	Aluminum reflector MIRO-Silver®
Power factor	0,95
Cooling	passive
Body	aluminum
Weight	0,54 kg
Package	Single / group
Life time	50 000 hours
Warranty	5 years/50 000 hours
Certification	CE, UKCA, UA

## Dimensions

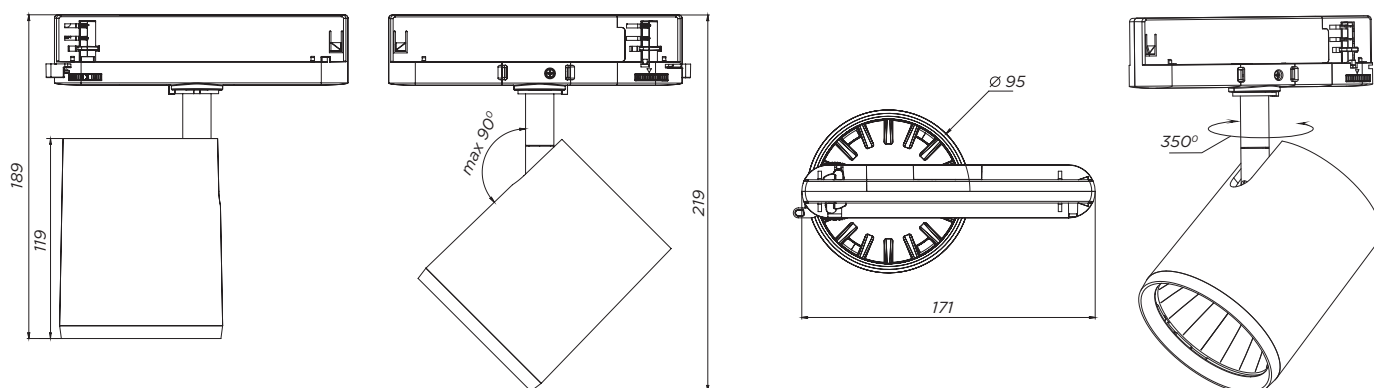

## Scope of application



# Mio 3PH-D

SPOT

## Nomenclature

Luminaire SPOT Mio						SO	60°	22W	840	3PH-D	IP21	BL
Order Type	Luminaire Filter Type	Luminaire Beam Angle	Luminaire Power, W	Luminaire Color Rendering Index (CRI)	Luminaire Color Temperature, K	Special Luminaire Light	Luminaire Mounting Type	Luminaire IP Rating	Luminaire Housing Color			
SO	HF	15°	13	8	3000	meat red	3PH-D	IP21	<b>BL</b> black RAL 9005  <b>WH</b> white RAL9016			
		15°S	15		3500	meat white						
		17°S	17		4000	meat vivid						
		24°	19	9	2700	elite						
		36°	22		3000	bread						
		36°S	24		3500	bread vivid						
		60°	27		4000	bakery						
		62°x34°	30			cheese						
		34°x62°	32			vegetables&fruits						
						vegetables&fruits vivid						
						fish white						
						fish vivid						
			fish									
			premium color 3000									
			bright color 3000									
			bright color 3500									
			bright color 4000									
			true white									
			premium white 3000									
			premium white 3500									
			premium white 4000									

The deviation of actual power consumption from the specified values does not exceed ±5%;  
 The luminous flux calculation is based on LEDs with a color temperature of 4000K, CRI80. The deviation of luminous flux from the specified values does not exceed ±10%

## Beam angle

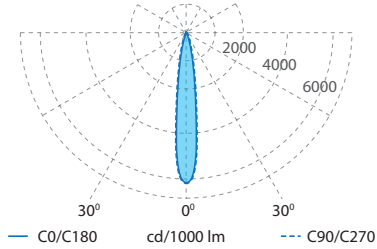

**15°**

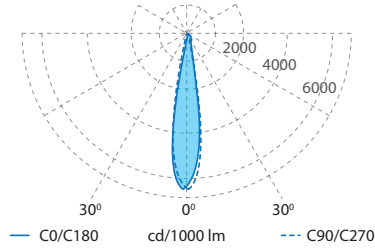

**15°S**

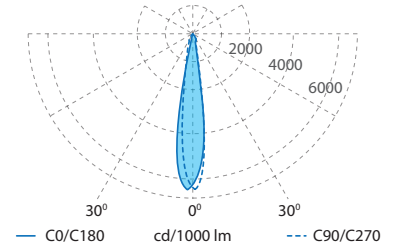

**17°S**

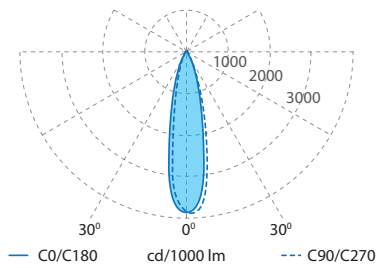

**24°**

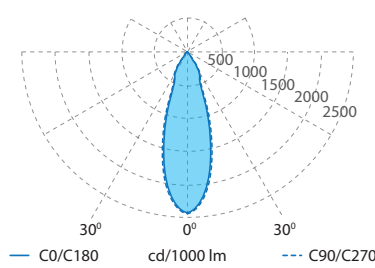

**36°**

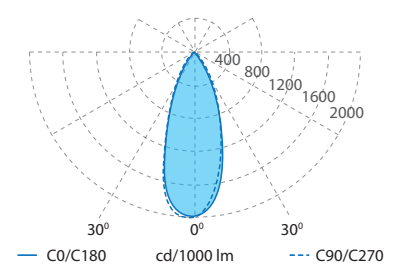

**36°S**

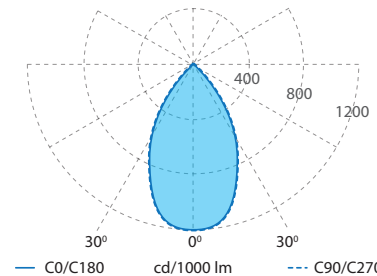

**60°**

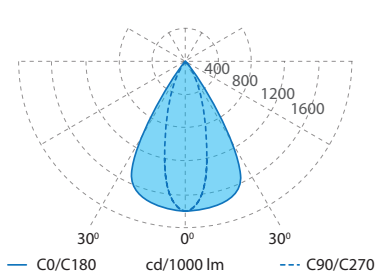

**62°x34°**

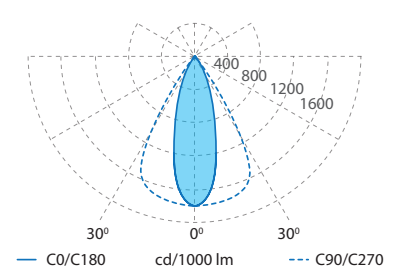

**34°x62°**

Technical details, as well as size and weight parameters were prepared as accurately as possible. All dimensions in mm. LED Lifetime Information - L90 / B10 at 25 °C ambient temperature. A tolerance of +/- 10% applies to luminous flux and performance characteristics. Minimum color rendering indices Ra > 80 / > 90. Product images are used as an example and may differ from the original. We reserve the right to make changes in order to improve the product.